



T650c Quick Start Guide



Get to know your T650c



! PASSCODES

For your security, certain functions, such as refunds, are protected by passcodes. If you need to set up or reset your passcode, call our Technical Helpdesk at **0800 EFTPOS (0800 338 767, option 2)** for assistance.

NOTE: You must be the listed authority on your Eftpos NZ account to set up or reset passcodes.

Getting started

1 Plug in power supply

Your terminal will arrive with the power cable and Ethernet cable already installed. Plug the power supply into a wall socket and switch on.



2 Power on the T650c

Press and hold the power button located on the left side of the T650c terminal. The terminal will power on and load the payment screen.



Connect to the internet

Via your internet router



Plug the other end of the Ethernet cable into a free LAN port on your router. Look for the Ethernet icon <...> at the top of the screen to confirm that your terminal is connected.

Via Wi-Fi

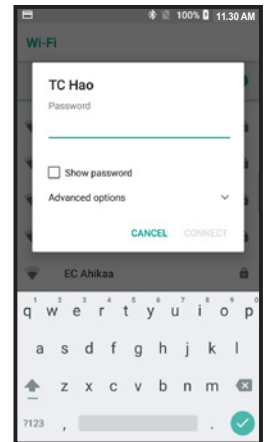
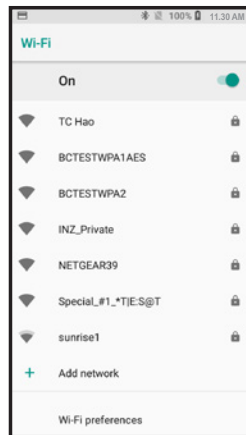
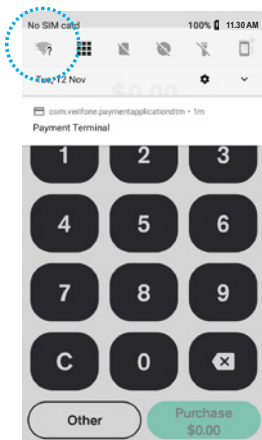

Connect to Wi-Fi

Swipe down from the notification bar at the top of the screen and tap and hold the Wi-Fi icon.

Find your network

Select your network.

Enter your password

Enter your Wi-Fi password and tap 'CONNECT'. Press the HOME BUTTON  to navigate back to the Payment screen.

Process a transaction

1



Enter the purchase amount and tap **Purchase**.
TIP: You can tap on the  icon to add a reference to the transaction

2



Your customer taps, inserts, or swipes their card or mobile wallet and enters their PIN if prompted

3

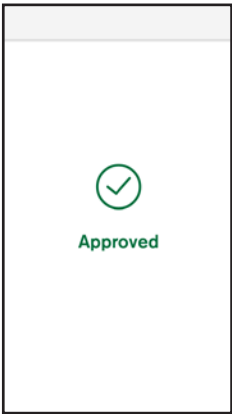

Terminal will display **Approved** or **Declined**

4

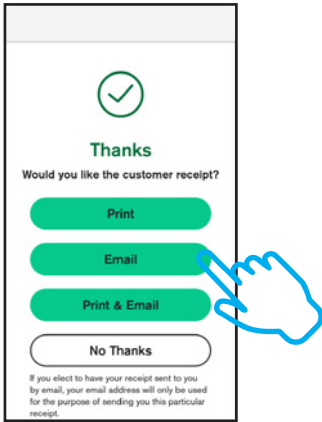

Customer selects how they would like to receive their receipt. Learn more: eftpos.co.nz/android-receipts

Changing the paper roll

1

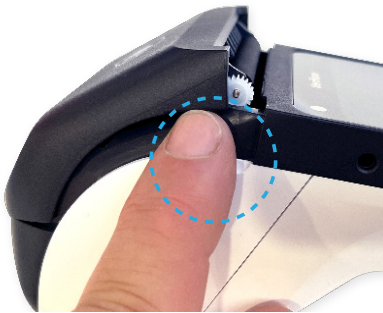

Open paper roll cover of the T650c as shown above. There are small slots to aid opening if required

2



Remove used paper roll. Insert new roll so the paper feeds from the top, leaving a length of paper sticking out of the terminal

3



Close the printer door, pressing down gently until it clicks shut



20% off Paper Rolls Online

Plus get **FREE SHIPPING**
on your first order

Use code: **WELCOME** at checkout



eftpos.co.nz/rolls



If you have any questions we are here
to help. Call us on **0800 EFTPOS**,
or visit **support.eftpos.co.nz**



0800 EFTPOS | 0800 338 767
www.eftpos.co.nz